

Item	PartNum	Qty	Description	Material	Pkg
1	1030-083	1	30x.250" NOM SHELL	SA-516 GR 70	
2	20-209	2	30" x .235 MIN JOGGLED HEAD	SA-414 GR G	
3	30-031	2	1-1/2" NPT HALF COUPLE 3000#	SA-105	
4	30-021	2	1/2" NPT COUPLING 3000#	SA-105	
5	30-005	1	1/4" NPT COUPLING 3000#	SA-105	
6	40-2152A	2	30" SADDLE BRACKET	Steel	
7	40-300A	2	LIFT LUG 1.5" OPENING	SA-36	
8	160-003LS	1	LIBERTY NAMEPLATE	Stainless Steel	
9	150-043	2	PROTECTOR	Vinyl	X
10	150-064	1	PROTECTOR	Vinyl	X
11	150-062	2	PROTECTOR	Vinyl	X

TACK WELD BRACKETS TO SHELL  
IN ORDER A-B-C, THEN FINISH WELD.

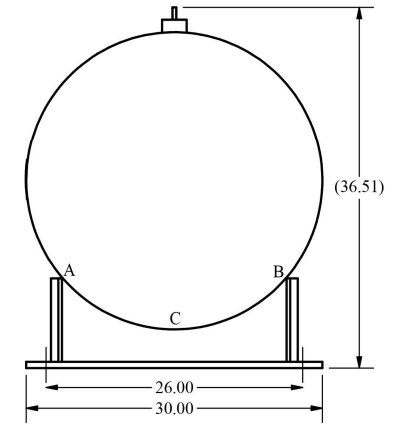

ENGRAVE CUSTOMER PART  
NUMBER IN PART/ TAG NO. BOX

NOTES:

1. ALL JOINT WELDED.
2. 225 PSIG MAX. WORKING PRESSURE.
3. FINISH: RAL-9005 BLACK POWDER PAINT.
4. PNEUMATIC TEST PRESSURE - 248 PSIG.
5. MANUFACTURE VESSEL IN ACCORDANCE W/ ASME SEC. VIII, DIV. 1 (LATEST EDITION) RULES FOR CONSTRUCTION.
6. MIN. DESIGN METAL TEMP. = -20°F.
7. MAX. DESIGN TEMP. = 500°F.
8. "U" STAMPING REQUIRED.
9. USE WPS MIG-1-PA OR WPS SUB-ARC-1-PA FOR ALL WELDING.
10. CORROSION ALLOWANCE: 0".

Tolerances unless otherwise specified			
0.000	= ± .060	Angular	= ± 2°
0.00	= ± .250	unless otherwise specified	
Description: 30" x 72" HORZ. RECEIVER			
Customer/Material: LIBERTY #43105			
Weight: 625#	Capacity: 193 GAL	Liberty Systems	
Date: 6/8/2020	By: SB	Part No.: RH3072D	Approved: